

STEPWOOD® Acoustic



STEPWOOD® acoustic combining design, nature and function

Benefits for eyes & ears

The STEPWOOD® design panel allows you to give a room high-quality and individual character. In combination with the different drilled holes, you are able to achieve an ideal acoustic solution.

STEPWOOD® already improves noise levels through its stepped surface in comparison to smooth surfaces. Through visually stunning all-over holes, we have created the basis of good sound absorption. The absorption value is determined by the building height and the insulation material.

We combine design, nature and function, and provide STEPWOOD® acoustic panels in different wood types, finishes and drilled holes for you. You will surely find the right type for your project!

Standard - Wood Types:



Oak



Walnut



Spruce



beech heartwood



Proofed and certified:
our production

www.acoustic4you.com m: (48) 513 074 118
office@acoustic4you.com

More D(e)sign in Wood

Certified Quality

Our newly developed STEPWOOD® acoustic panels underwent laboratory acoustics and noise control tests at TÜV (Technical Inspection Authority) Rheinland.

The sound absorption rating (α_w) of STEPWOOD® panels in spruce and core beech with different drilled holes was measured.

The test results are very satisfactory: e.g. Spruce panels with drilled holes R4.5 D2: high absorption (absorption class C): sound absorption rating (α_w) = 0.75

Core beech panels with drilled holes R4.5 D1.2: sound absorption rating (α_w) = 0.40 with high sound absorption coefficient of > 0.8 in the frequency range of about 160-500 Hz

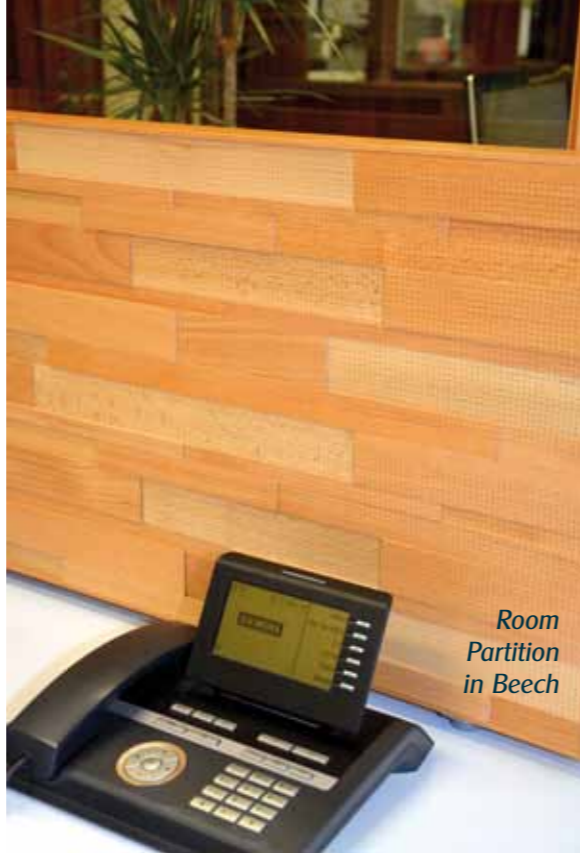

Room Partition in Beech



Ceiling Panels in Walnut

STEPWOOD® acoustic panels can be used for wall panelling, fronts and partitions.



1,250 mm

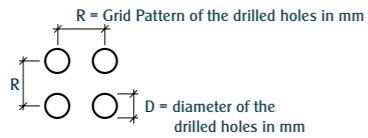
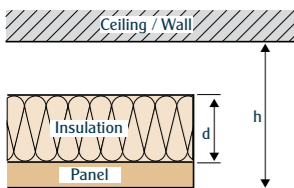

h = Complete height of structure
d = thickness of insulation
1 = 100% sound absorption

Data according to DIN EN ISO 354

Data source: Certificate LGA/TÜV
Valid for: Wall and ceiling
Fleece: black acoustic fleece
Insulation: Sonorock or equivalent

Wood Type:

Oak, walnut, spruce, beech heartwood

Surface:

matt lacquered or raw

Panel Size:

L 1,250 x W 219 mm
(0.274 m² covered surface)

Carrier:

6 mm MDF

Back:

Acoustic Fleece V100

Packaging:

1 box = 5 panels

Each panel is complete for a clean and easy assembly.

Matching mounting material in stock.



Screen in Oak

STEPWOOD® Acoustic SWAK.B2R4

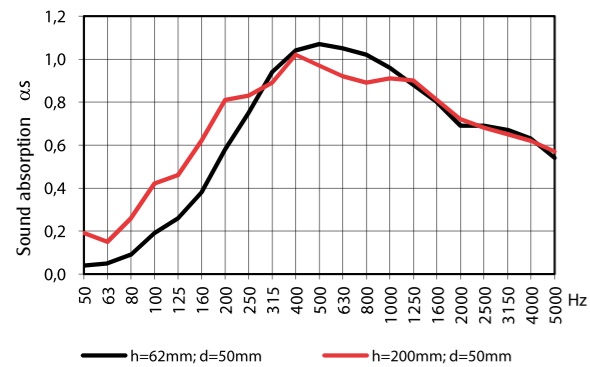

table α_s , α_p , α_w

Hertz	50	63	80	100	125	160	200	250	315	400	500	630	800	1000	1250	1600	2000	2500	3150	4000	5000	
h=62mm; d=50mm	0,04	0,05	0,09	0,19	0,26	0,38	0,58	0,75	0,94	1,04	1,07	1,05	1,02	0,96	0,88	0,80	0,69	0,69	0,67	0,63	0,54	avr: 0,75
h=200mm; d=50mm	0,19	0,15	0,26	0,42	0,46	0,62	0,81	0,83	0,89	1,02	0,97	0,92	0,89	0,91	0,90	0,81	0,72	0,68	0,65	0,62	0,57	avr: 0,75
SAK				0,30		0,75		1,05		0,95		0,95		0,60		0,35		0,25		0,25		SAK: 0,69
SAK				0,50		0,85		0,95		0,90		0,75		0,60		0,35		0,25		0,25		SAK: 0,64

STEPWOOD® Acoustic SWAK.B1R4

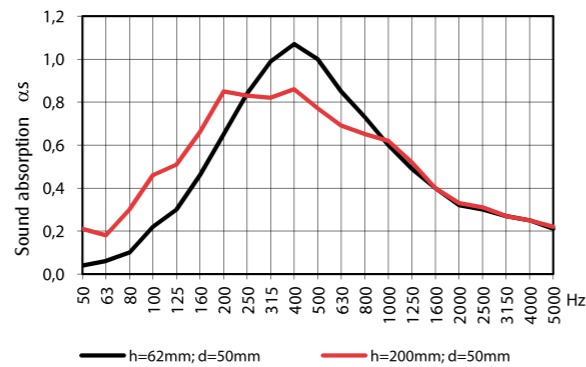

table α_s , α_p , α_w

Hertz	50	63	80	100	125	160	200	250	315	400	500	630	800	1000	1250	1600	2000	2500	3150	4000	5000	
h=62mm; d=50mm	0,04	0,06	0,10	0,22	0,30	0,46	0,65	0,84	0,99	1,07	1,00	0,85	0,73	0,60	0,49	0,40	0,32	0,30	0,27	0,25	0,21	avr: 0,40
h=200mm; d=50mm	0,21	0,18	0,30	0,46	0,51	0,66	0,85	0,83	0,82	0,86	0,77	0,69	0,65	0,62	0,52	0,40	0,33	0,31	0,27	0,25	0,22	avr: 0,40
SAK				0,35		0,85		0,95		0,95		0,60		0,35		0,25		0,25		0,25		SAK: 0,69
SAK				0,55		0,85		0,75		0,60		0,35		0,25		0,25		0,25		0,25		SAK: 0,64



STEPWOOD® Acoustic B1R4
Drilled holes 1.2 mm, Grid Pattern 4.5 mm



The grooved back panel covered in acoustic fleece



All sides panel grooved on

STEPWOOD® Acoustic